

IEEE 802 Plenary Session

Caribe Royale Convention Center, Orlando, FL

Mid-Session Network Services Report

March 19, 2008

Summary

VeriLAN Event Services, Inc. (VeriLAN) is providing comprehensive network services for the IEEE 802 March 2008 Plenary meeting at the Caribe Royale Convention Center located in Orlando, FL. We are pleased to report that after resolving minimal issues with the onsite infrastructure, the network is stable and supporting in excess of 1400 wireless clients.

Issue: Global power outages on Tuesday & Wednesday caused the network servers to reboot. These interruptions are indicated as breaks in the Internet usage graphs, due to the server clock resetting to 00:00.00 hours.

Resolution: Servers were brought back online.

The VeriLAN Network Help Desk is providing support for all attendees during scheduled meeting hours. All Help Desk support requests were addressed and fully resolved by VeriLAN staff.

The property is fed by a 45Mbps symmetrical DS3 connection to the Internet. We were given unrestricted access to the bandwidth, which is shared with the guest rooms and administrative offices. The shared Internet bandwidth was provided at no charge to IEEE guest rooms over the hotel's wired and wireless network. The measured network latency is low, indicating that we are fitting well within the line capacity. Network traffic statistics are shown in Figure 1. Internet usage for the last 24 hour period is shown in Figure 2. Internet usage for the last seven days is shown in Figure 2. Internet usage for the last twelve months is shown in Figure 4.

Interface	Period	Direction	Current rate	Hour	Day	Week	Month
LAN-SECURE (3)	Current	In	3.0 Mbits/s	115.4 MB	1.1 GB	2.2 GB	5.7 GB
		Out	417.3 Kbits/s	11.0 MB	817.0 MB	3.7 GB	3.7 GB
	Previous	In		680.4 MB	0.0 KB	0.0 KB	0.0 KB
		Out		87.4 MB	0.0 KB	0.0 KB	0.0 KB
Manage	Current	In	28.6 Kbits/s	1.3 MB	98.0 MB	6.0 GB	6.5 GB
		Out	402.6 Kbits/s	14.3 MB	705.5 MB	6.9 GB	16.9 GB
	Previous	In		9.5 MB	0.0 KB	0.0 KB	0.0 KB
		Out		84.7 MB	0.0 KB	0.0 KB	0.0 KB
OPEN	Current	In	5.4 Mbits/s	224.3 MB	10.5 GB	71.4 GB	75.1 GB
		Out	22.9 Mbits/s	777.3 MB	35.1 GB	203.7 GB	203.8 GB
	Previous	In		1.2 GB	0.0 KB	0.0 KB	0.0 KB
		Out		4.2 GB	0.0 KB	0.0 KB	0.0 KB
	Current	In	23.7 Mbits/s	803.6 MB	36.6 GB	214.5 GB	224.4 GB
		Out	8.5 Mbits/s	341.2 MB	11.6 GB	79.4 GB	79.7 GB
Previous	In		4.4 GB	0.0 KB	0.0 KB	0.0 KB	
Out			1.9 GB	0.0 KB	0.0 KB	0.0 KB	

Figure 1. Internet Traffic Statistics

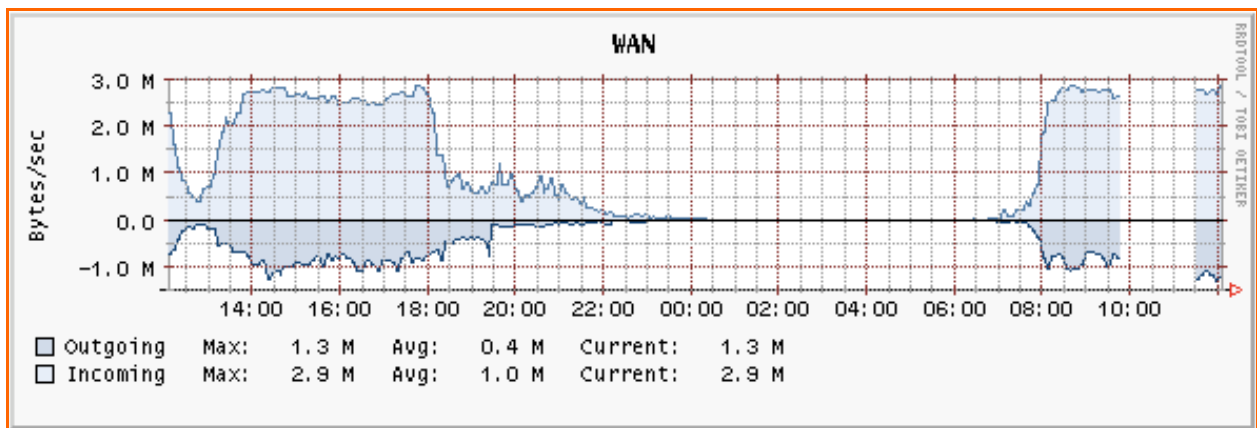

Figure 2. Internet Usage: past 24 hours (EST)

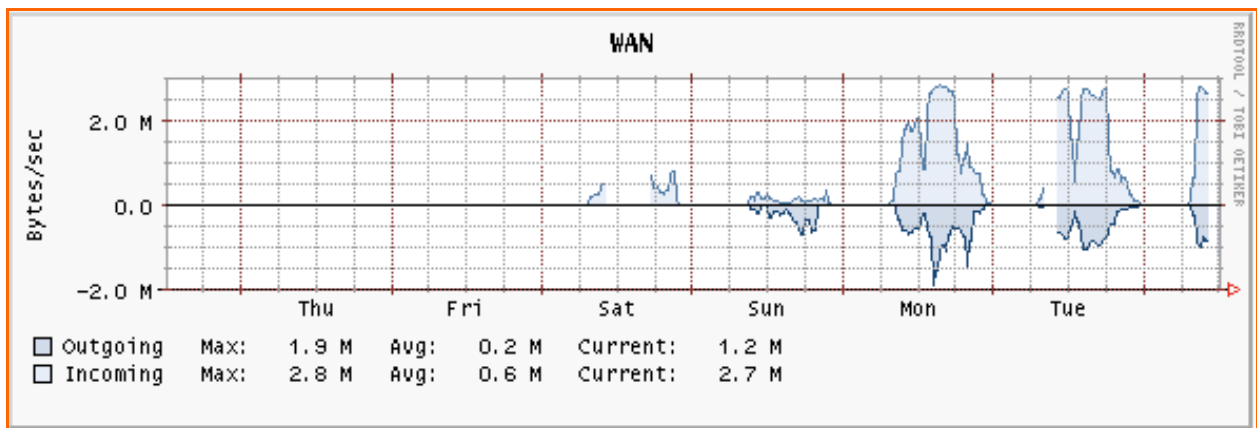

Figure 3. Internet Usage: past 7 days

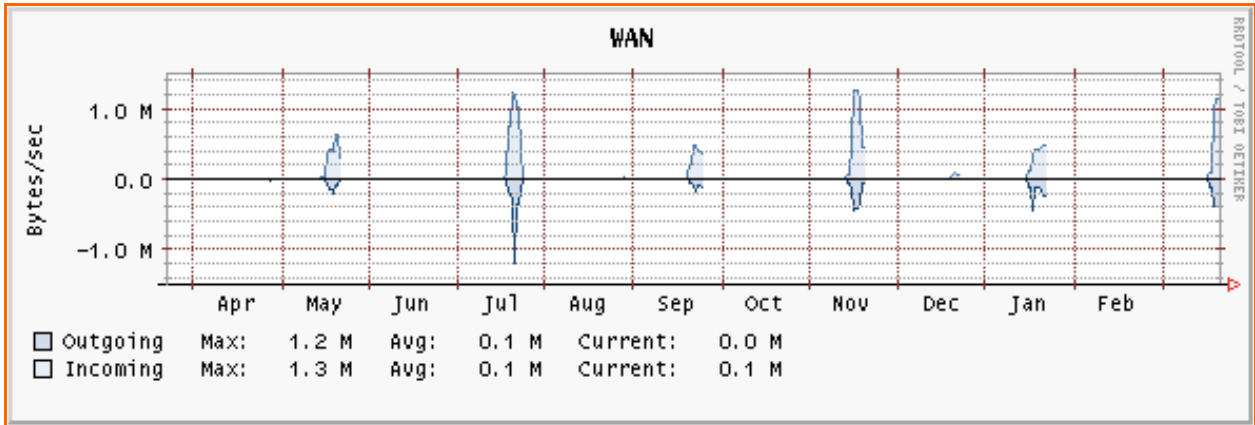

Figure 4. Internet Usage: past 12 months

Network Deployment & Coverage

VeriLAN deployed 69 enterprise grade tri-modal IEEE 802.11a/b/g wireless access points throughout the Caribe Royale Convention Center to provide coverage for all meeting spaces. Target association density was 40 clients per WAP. VeriLAN is providing both Open and Secure (802.1x) networks to registered attendees. Figure 5 illustrates the location of the WAP deployments. Figure 6 illustrates the optimum (5 bar) coverage of the WAP deployments.

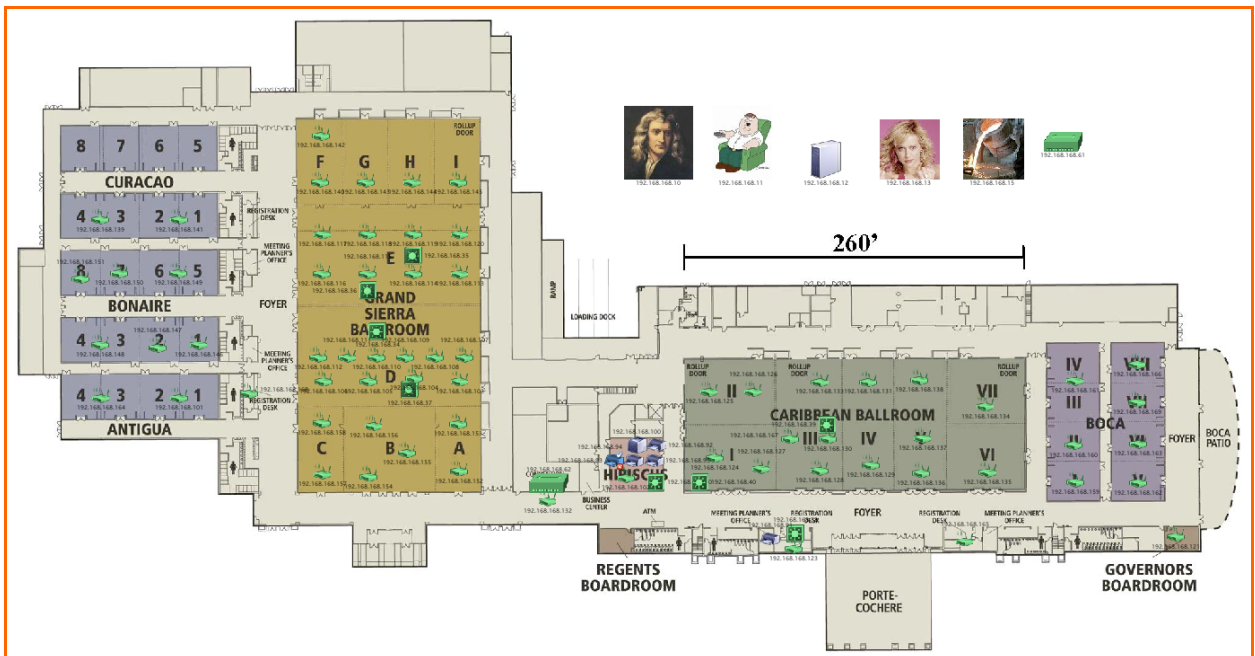

Figure 5. Wireless Access Point Deployment Plan

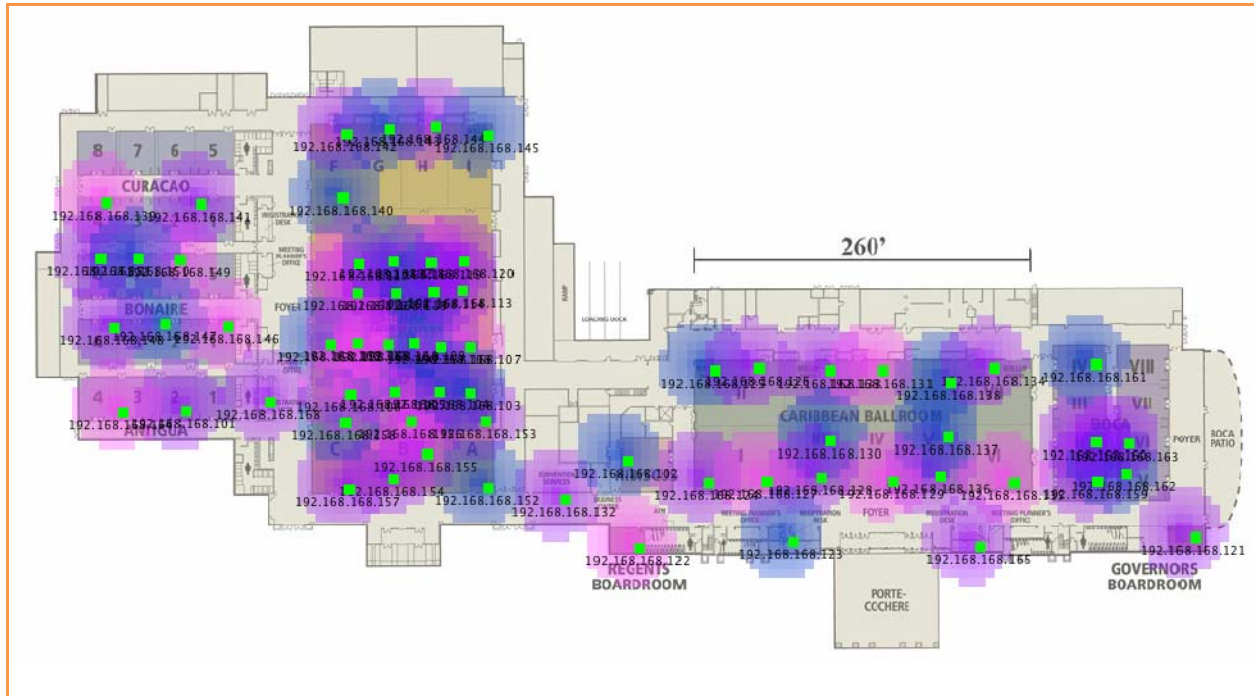

Figure 6. Caribe Royale Convention Center Wireless Coverage: Full coverage of meeting space with proper channel separation. Note: Radiation bubble shows transmit power and is not relative to reception range. Good reception (>70%) is typically available at double the distance.